

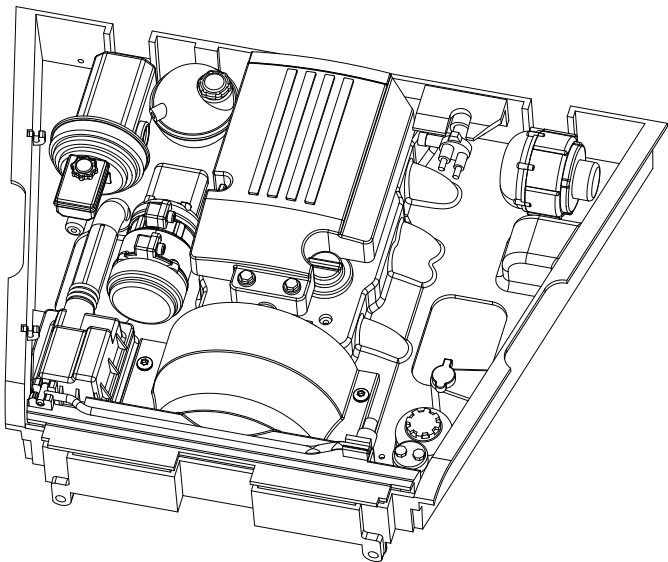

# **RC4WD TDI ENGINE BAY FOR 2015 LAND ROVER DEFENDER D90**



## ***Instruction Manual Symbols Key***



CA Glue



Trim with Hobby Knife



Attention



Cut with Scissors



Drill Hole



Paint



Body Reamer

## ***Recommended Tools***

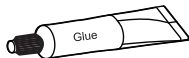

(Foam safe CA, Shoe Goo, E6000, Styrene Glue, Epoxy)

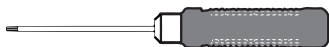

Hex Drivers (1.5mm, 2mm)

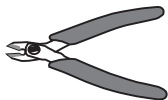

Side Cutters



Hobby Knife



## ***Tips for Assembly***

1. Use good quality hex drivers to avoid stripping screw heads.
2. Use "Step" index for quantity and size of hardware to be used for assembly
3. Do not overtighten screws.
4. Carefully remove all pieces from parts trees with a hobby knife or side cutters. Take care to trim the injection point from the parts.
5. Test fit everything before gluing. Many areas will require extra attention to detail to ensure proper alignment.

## ***Warranty***

RC4WD non-electrical products are warranted to be free of defects in materials and workmanship when new. Our limited warranty does not cover damages due to normal wear and tear, user error of assembly or installation, user modifications, user's failure to perform routine maintenance, addition of aftermarket parts or option parts. This warranty lasts 30 days after arrival for original purchaser.

In the event of a defect under this warranty, RC4WD will, at our discretion, replace the product, provided our inspection indicates that an original defect exists. RC4WD reserves the right to replace any product which is no longer available with a product of comparable value and function. If RC4WD determines the repair is not covered under warranty guidelines, we will contact you to discuss your options. If you have any questions, please contact us via email at [support@rc4wd.com](mailto:support@rc4wd.com).

RC4WD warrants its electronics for 30 days from date of arrival. This covers all electrical items except items that are already noted on the individual product page.

# Parts List-1

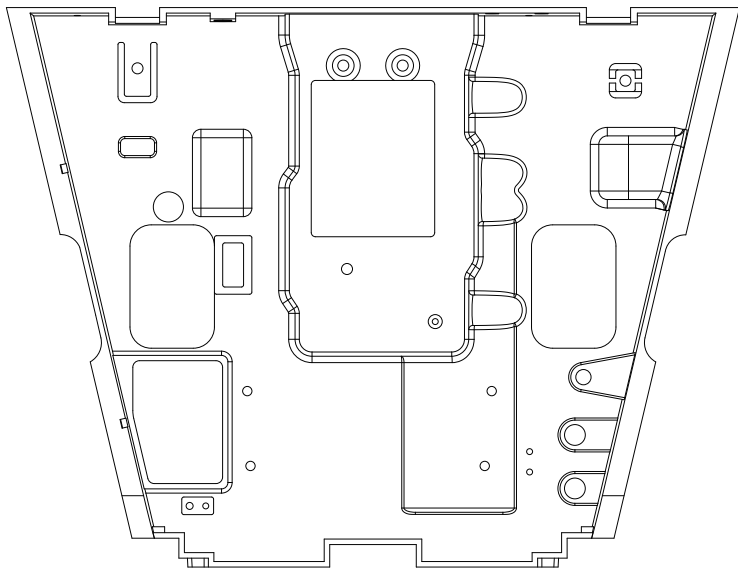

325-1450



325-1451

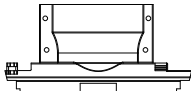

325-1452

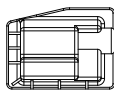

325-1453

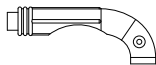

325-1454

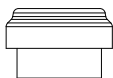

325-1455

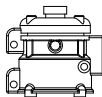

325-1456

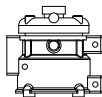

325-1457

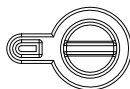

325-1458

## Parts List-2



325-1459

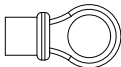

325-1460



325-1461



325-1462



325-1463

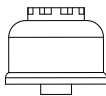

325-1464

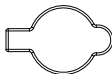

325-1465

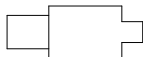

325-1466



325-1467



325-1468

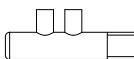

325-1469



325-1470

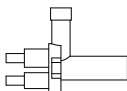

325-1471

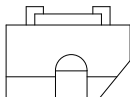

325-1472



325-1473

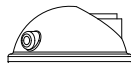

325-1474

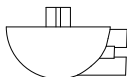

325-1475



325-1476



325-1477



325-1478



X3

150-0327  
M1.6 x 4mm SHSTS



X9

150-0245  
M2.5 x 4mm BHSTS



X2

150-0171  
M2.5 x 8mm BHSTS



## RC4WD TDI Engine Bay for 2015 Land Rover Defender D90

### Step 1.

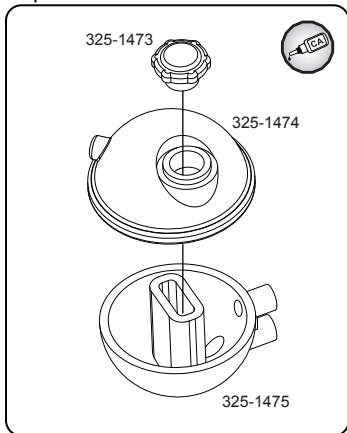

### Step 2.

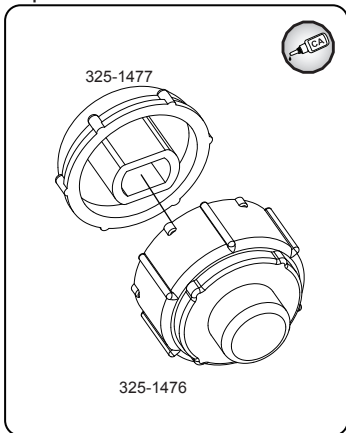

### Step 3.

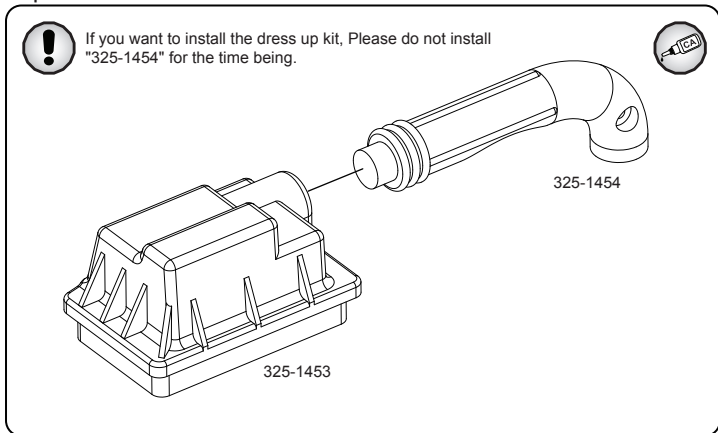



## RC4WD TDI Engine Bay for 2015 Land Rover Defender D90

Step 4.

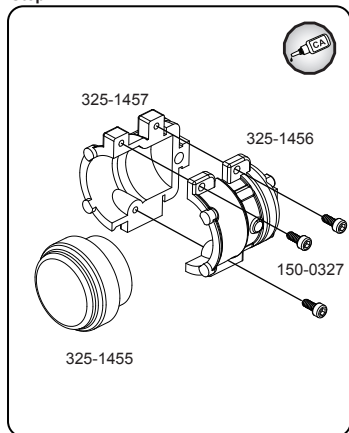

Step 5.

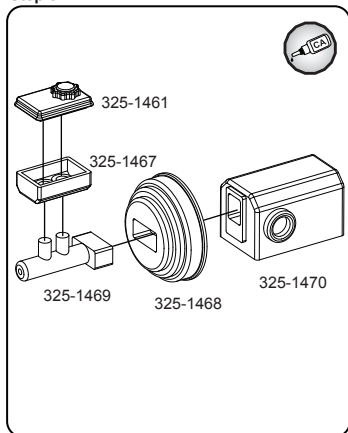

Step 6.

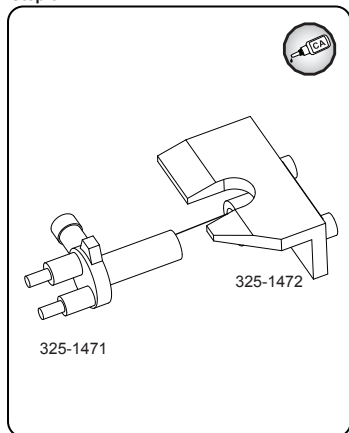

Step 7.

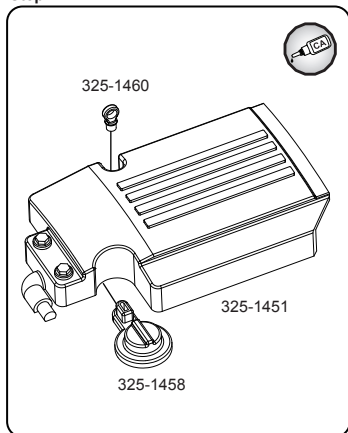



## RC4WD TDI Engine Bay for 2015 Land Rover Defender D90

### Step 8.

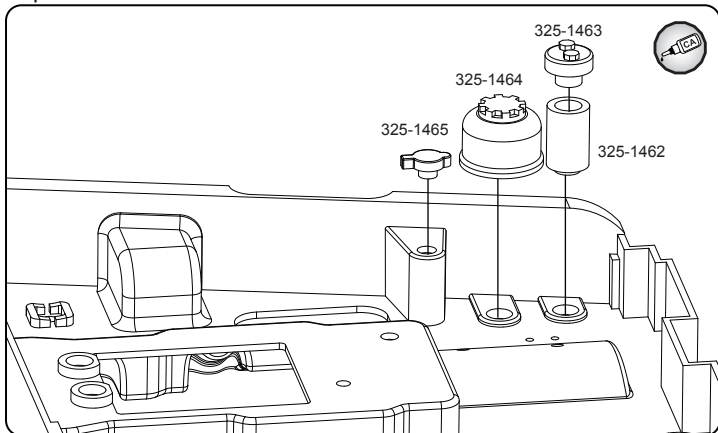

### Step 9.

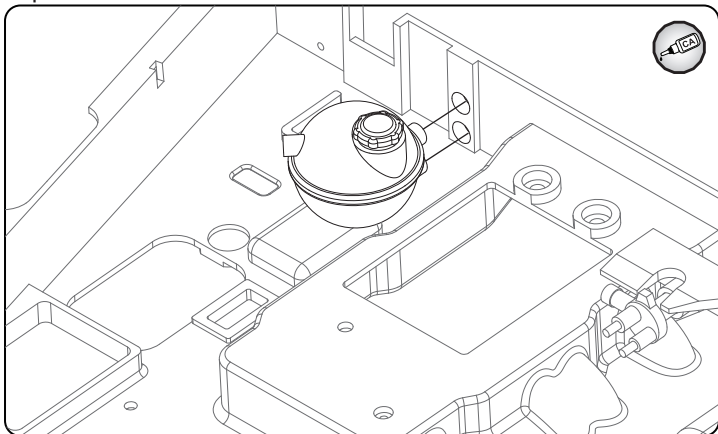



## RC4WD TDI Engine Bay for 2015 Land Rover Defender D90

Step 10.

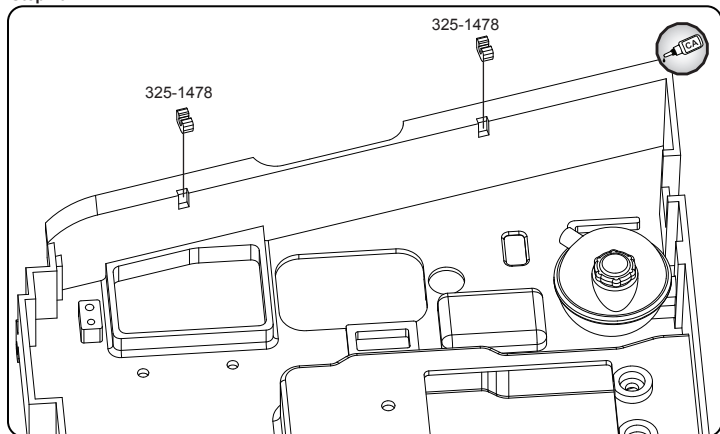

Step 11.

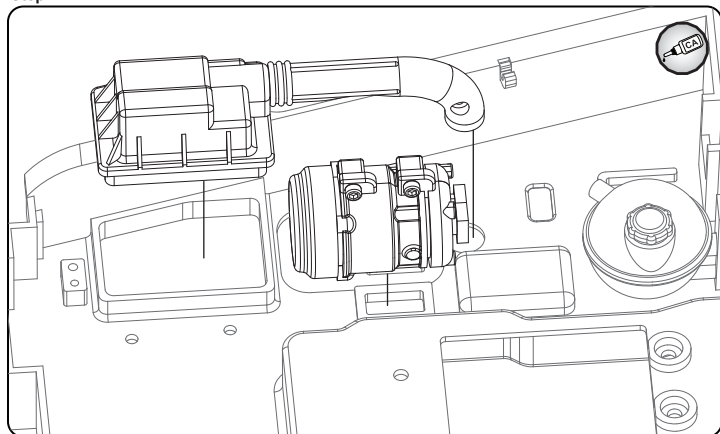



## RC4WD TDI Engine Bay for 2015 Land Rover Defender D90

Step 12.

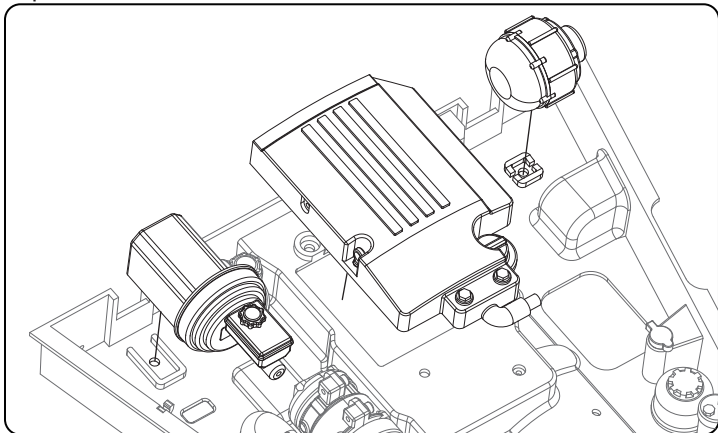

Step 13.

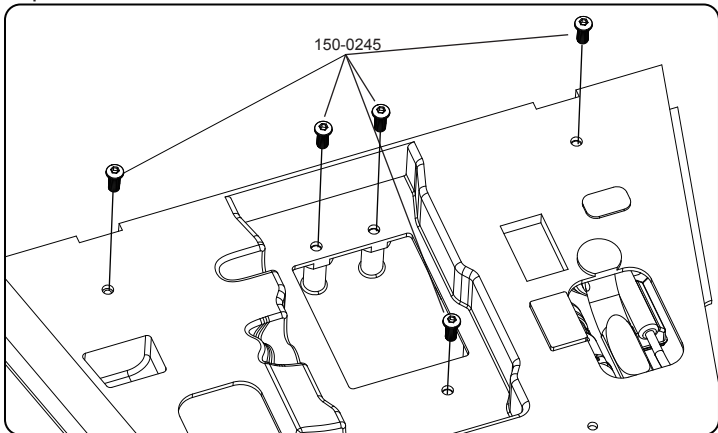





## RC4WD TDI Engine Bay for 2015 Land Rover Defender D90

Step 14.

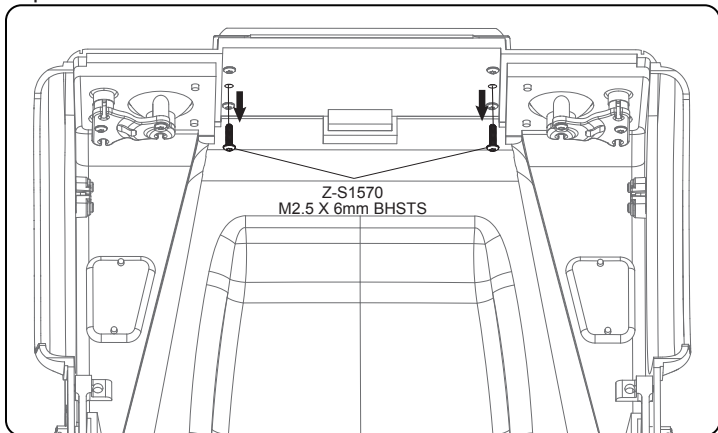

Step 15.

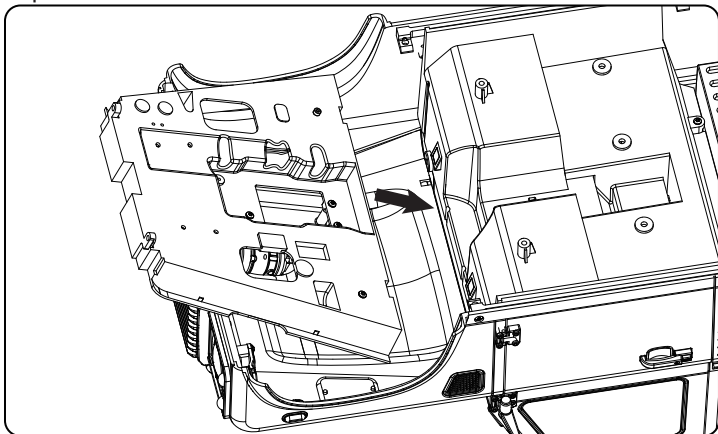



## RC4WD TDI Engine Bay for 2015 Land Rover Defender D90

### Step 16.

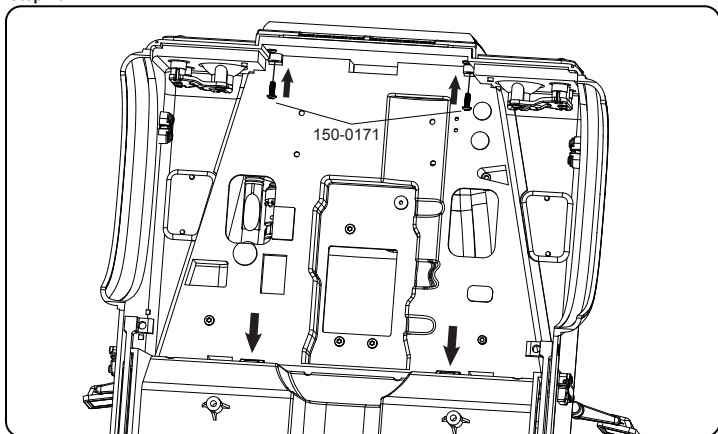

### Step 17.



Note that part "325-1459" does not require glue.

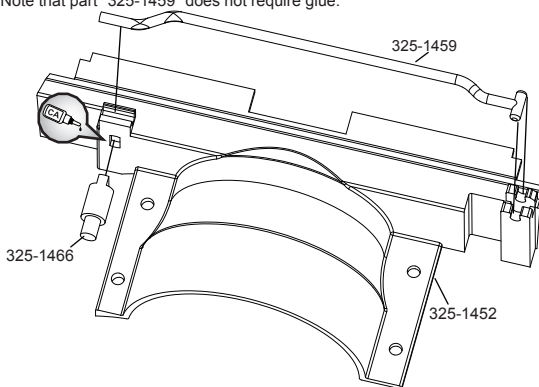



## RC4WD TDI Engine Bay for 2015 Land Rover Defender D90

**Step 18.**

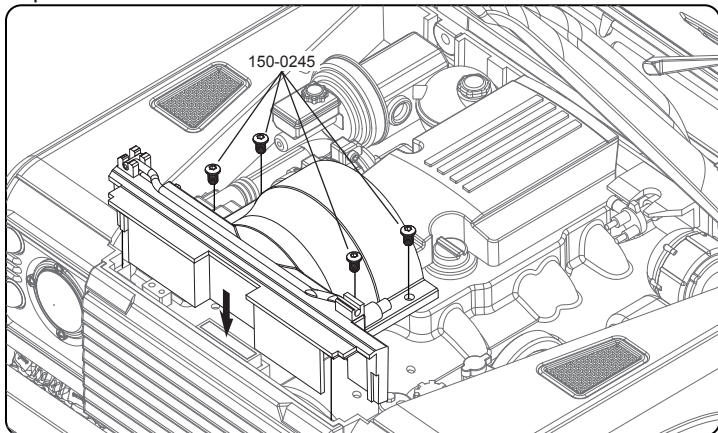

**Step 19. Apply stickers.**

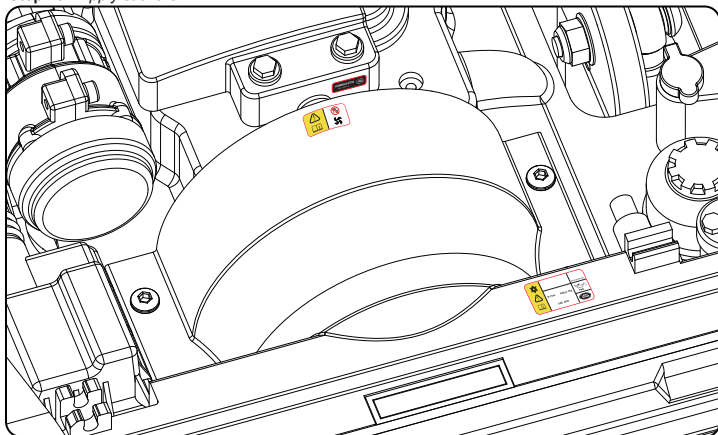



## RC4WD TDI Engine Bay for 2015 Land Rover Defender D90

**Step 20.** *Apply stickers.*

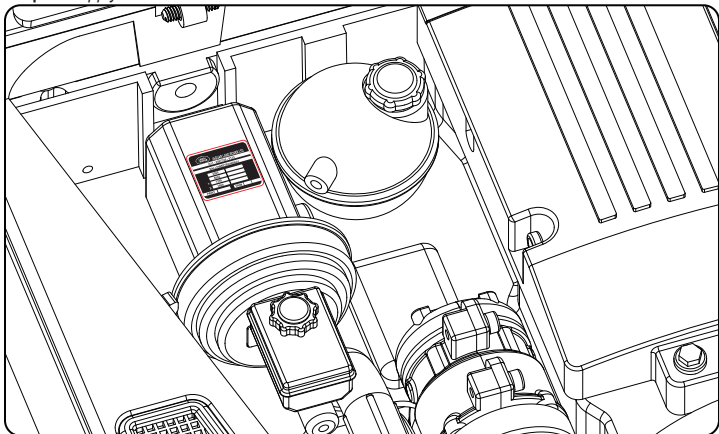

**Step 21.** *Installation Complete!*

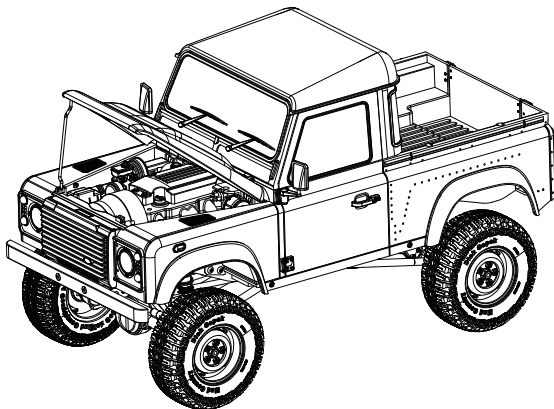



## RC4WD TDI Engine Bay for 2015 Land Rover Defender D90

**Step 22.** \*The following are steps for installing Z-S0437 which is not included in this kit.

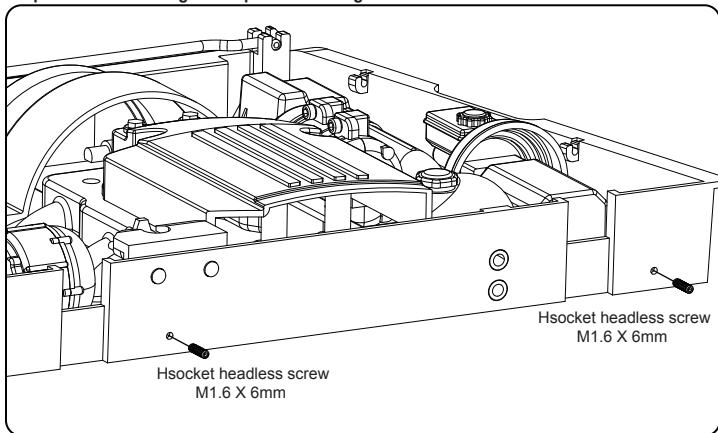

**Step 23.**

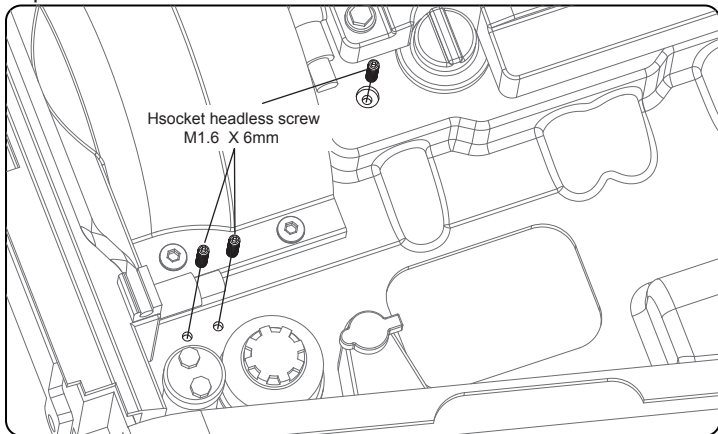



## RC4WD TDI Engine Bay for 2015 Land Rover Defender D90

Step 24.

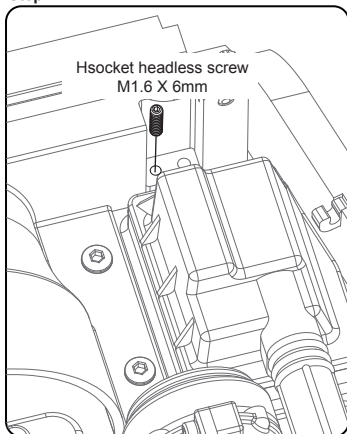

Step 25.

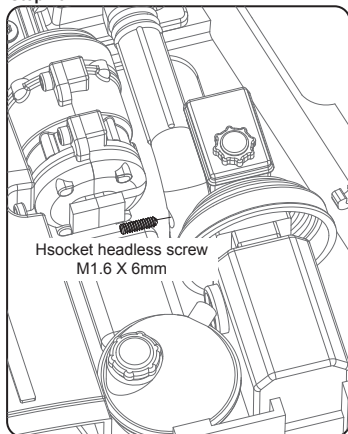

Step 26.

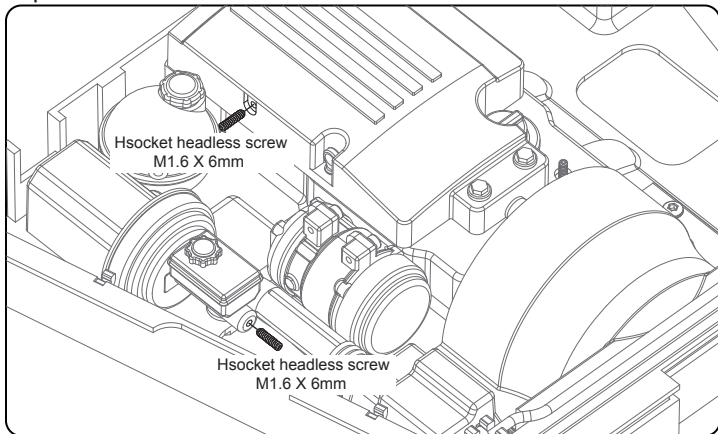



## RC4WD TDI Engine Bay for 2015 Land Rover Defender D90

**Step 27.** \*The following are steps for installing Z-S0437 which is not included in this kit.

Z-S0437 RC4WD Dress Up Kit for TDI Engine Bay.

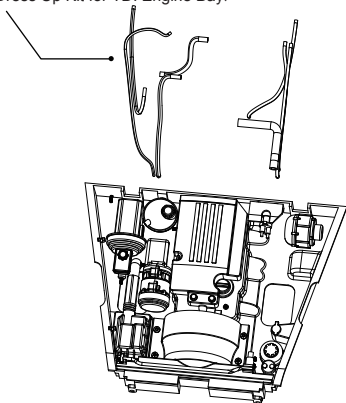

**Step 28.**

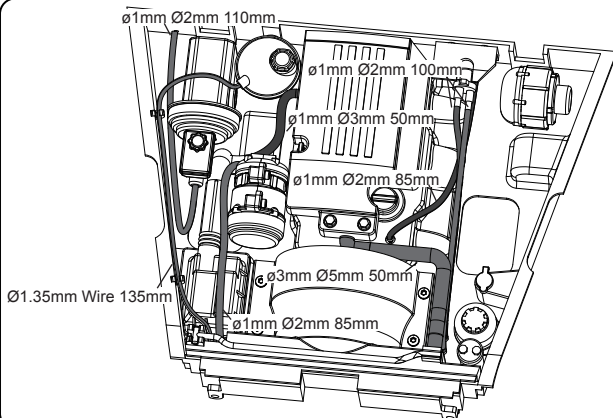



[www.rc4wd.com](http://www.rc4wd.com)



**RC4WD**

737 N. Gateway St.

Visalia, CA 93291

Web: [www.rc4wd.com](http://www.rc4wd.com) - Email: [support@rc4wd.com](mailto:support@rc4wd.com)

100-0147